

# Hubflow

67-68 LONG ACRE,  
COVENT GARDEN, WC2E 9JD  
4TH FLOOR

AVAILABLE NOW

## FULLY SERVICED OFFICE SPACE COVENT GARDEN

ALL INCLUSIVE  
PRICE FROM

£19,950 PCM

HUBFLOW PROVIDES A 'BESPOKE' TURN-KEY  
SOLUTION TO MEET ALL OF YOUR REQUIREMENTS

23 - 35 DESKS

SELF-CONTAINED FLOOR

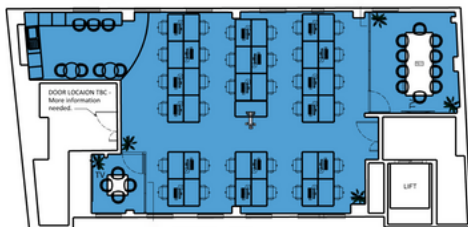

LAYOUT - HUBFLOW MAX

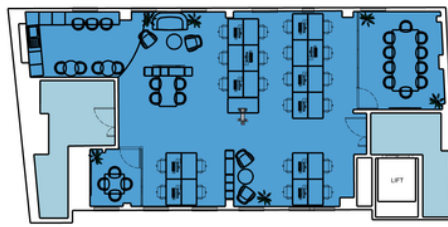

LAYOUT - HUBFLOW LITE



HUBFLOW WHITE LABEL

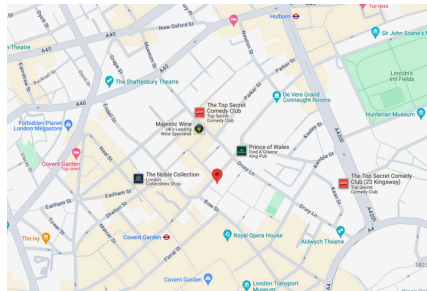

LOCATION

### PROPERTY OVERVIEW

- Flexible Terms
- Breakout Space
- Cost Competitive
- CAT A Cabling
- Dedicated WiFi
- Reception Area
- Meeting Rooms
- Showers
- Board Room
- Fitted Kitchen

### TRANSPORT HUBS

- Covent Garden (2mins)
- Charing Cross (10 mins)
- Cycle Lanes
- Key Bus Routes
- Bustling London Zone 1 Location

Hubflow

0330 088 7358

hubflow.com

enquiries@hubflow.com

Trustpilot

